

Carrington™ Model  
**Single Bowl Packages**  
 CLS1515D7BFS1  
 CLS1515D7BFS2

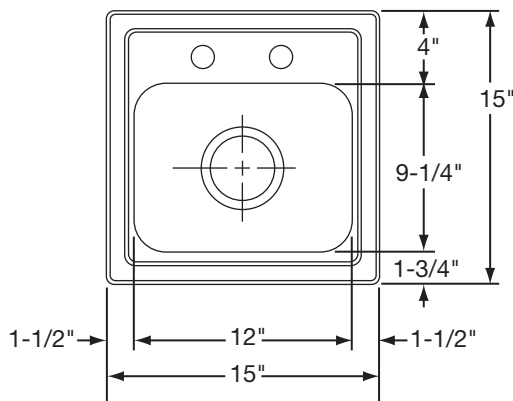

Model CLS1515D7BFS1

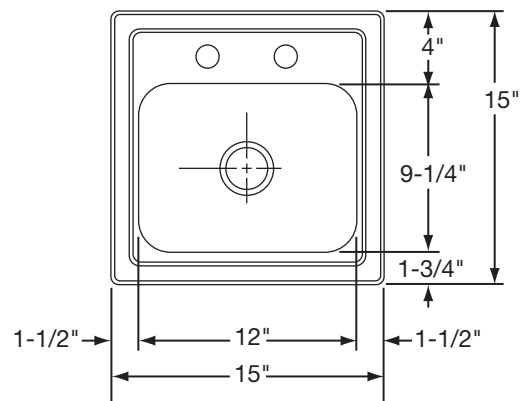

Model CLS1515D7BFS2

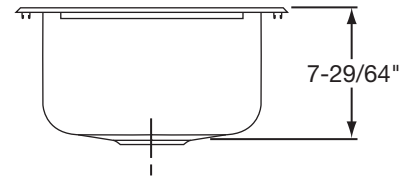
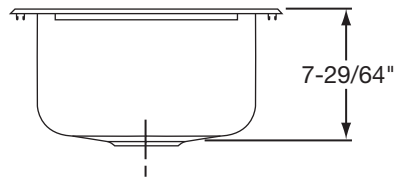

## FEATURES:

- 20 GA 304 Nickel-Bearing Stainless Steel
- Self-Rimming / Drop-In
- 2" or 3-1/2" Center Drain Opening
- Full Undercoat Sound Deadening
- BF Faucet
- S1 or S2 Strainer
- Mirror Rim Radius
- Diamond-Glo Finish
- Includes Mounting Hardware/ Clips and Screws
- Hole Drillings: 2
- Suggested Cabinet Size: 18"
- Shipping Weight: 9-1/2 lbs.

ALL DIMENSIONS IN INCHES, TO CONVERT TO MILLIMETERS MULTIPLY BY 25.4.

In keeping with our policy of continuing product improvement, Revere Sink reserves the right to change product specifications without notice.

This specification describes a Revere Sink product with design, quality and functional benefits to the user. When making a comparison of other producers' offerings, be certain these features are not overlooked.